

Lift

Complementary products

Push buttons - IP65 □ protections - Buzzer



LIFT TECHNOLOGY

PUSH BUTTONS

**Yellow Flush push button
ALARM**



PPRN3A

**Black Flush push button
LIGHT**



PPRN8L

**Blue Flush button
COMMON**



PPRN4/C

**White Flush button
UP**



PPRN5/F

**White Flush button
DOWN**



PPRN8/F

**Multi-function
UP-DOWN**



IP54

PPDNR.3

**Multi-function
UP-DOWN**



IP54

PPDNR.9

**Mushroom Ø40
PUSH-PULL LIGHTED**



PPFL1P4N

Mushroom guard



11706006

Knob guard



Ø 42 | 11705051
Ø 50 | 11705075

FOR CAM SWITCHES

**BUZZER AC/DC 12-24V
90 dB/30cm**



PPESV812

CONTINUOUS TONE





Lift

Complementary products

Switch - Disconnectors

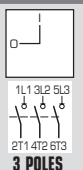
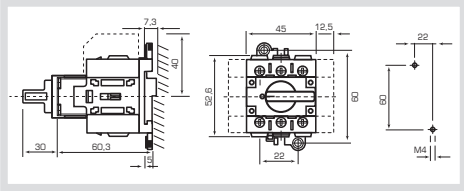
BASE FIXING WITH DIRECT COMMAND

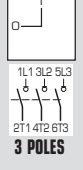
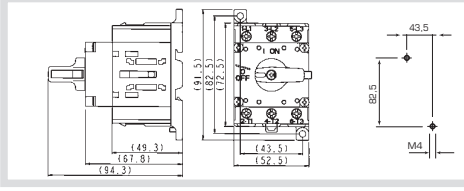
- Comply with rules, IEC 947-3, EN60947-3, UL 508
- Box fixing and DIN Rail 50022-35
- Black knob with locking in position O - OFF
- Protection Class Terminals IP20

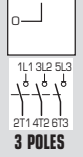
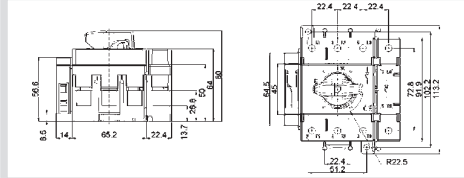
	RANGE	SCHEME	CODE	
	SQ032 SERIES AC-22A 32A-690V	 1L1 3L2 5L3 2T1 4T2 6T3 3 POLES	SQ032003DL1N	
	SQ063 SERIES AC-22A 80A-690V	 1L1 3L2 5L3 2T1 4T2 6T3 3 POLES	SQ063003DL2N	
	SQ125 SERIES AC-22A 125A-690V	 1L1 3L2 5L3 2T1 4T2 6T3 3 POLES	SQ125003DL2N	

ELECTRICAL CHARACTERISTICS

CHARACTERISTICS IEC/EN60947-3			SQ032	SQ063	SQ125
Rated insulation voltage U_i	V		690	690	800
Rated impulse withstand voltage U_{imp}	kV		8	8	8
Rated thermal current I_{th-lth}	A		40	80	125
Frequency	Hz		50/60	50/60	50/60
RATED OPERATING CURRENT I_e :					
AC-21A Switching resistive loads with light overloads	690V	A	40	80	125
AC-22A Switching mixed resistive and inductive loads at light overloads	690V	A	32	80	25
AC-23A Periodic switching of motors or other overloads	3 phases - 3 poles	230V	32	75	125
		400/500V	32	67	125/100
	690V	A	20	32	80
Nominal interruption power AC-23A (cos ϕ 0,45)	400V	A	256	536	1000 (cos ϕ 0,35)
Short circuit characteristics		kA	10	10	10,5
Fuse rating qG	690V	A	40	63	125
Terminal capacity	Flexible conductors	mm ²	1,5-10	6-25	10-70
		mm ²	1,5-16	10-35	10-70
		AWG	12-6	10-2	-
General Use UL 508	600Vac	A	40	80	-

- Standard version 3 poles, possible extra mounting of three types of contacts: power contacts, neutral, ground and auxiliaries contacts NC and NO.
- cUL approvals on SQ032 and SQ063 series.

Lift

Complementary products

Limit Switches - Cam Switches



LIFT TECHNOLOGY

LIMIT SWITCHES IP65 - □

VARIABLE LENGTH ROLLER LEVER Ø 18



Minimum tripping force 0,10 N
Snap Action contacts

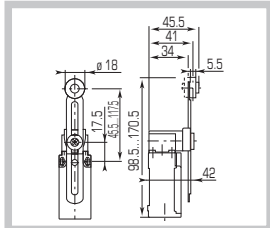
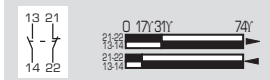

FT139Z11

VARIABLE LENGTH ROLLER LEVER Ø 45



Minimum tripping force 0,10 N
Snap Action contacts

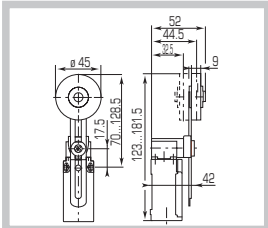
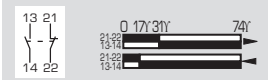

FT140Z11

RUBBER ROLLER LEVER Ø 45



Minimum tripping force 0,10 N
Snap Action contacts

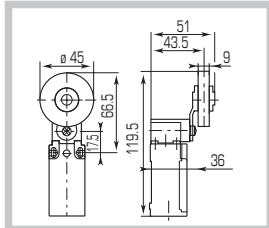
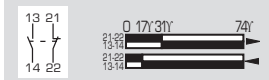

FT141Z11

CHARACTERISTICS

Comply with:
IEC 947-5-1, EN60947-5-1,
UL508, CSA 22.2 n°14.
Certifications: cUL
Rated insulation voltage U_i 690V
Rated thermal current I_{th} 10A
Rated operating current I_e :
AC-15 24V-10A DC-13 24V-2,8A
120V-6A 120V-0,55A
230V-3,1A 230V-0,27A
380V-1,9A -
UL 508 Designation A600-Q600

DIMENSION

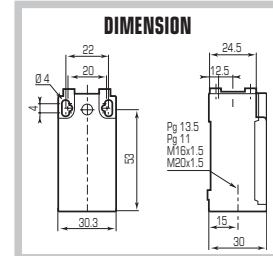

CAM SWITCHES



SWITCHING

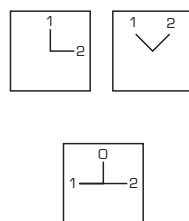

SCHEME

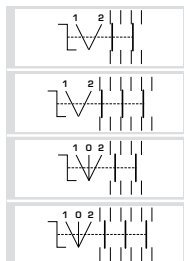

CODE

P0160100S
P0160101S
P0160112S
P0160138S





CHARACTERISTICS

Certifications: cUL, IMQ, CCC, GOST
Comply with rules: IEC 947-3, EN60947-3, UL508
Rated insulation voltage U_i 690V
Rated thermal current I_{th} 20A - I_{the} 16A
Rated operating current I_e :
AC-21A - AC-22A 16A - 690V
DC-21A (1 pole) 12A - 50V
DC-22A (1 pole) 10A - 30V
Protection Class Terminals IP20
Flexible conductors mm^2 n.1x0,75/4...n.2 0,75/2,5
Solid conductors mm^2 n.1x0,75/4...n.2 0,75/2,5
AWG 16 - 12
Genera Use UL 16A - 600Vac

Lift

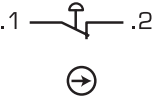
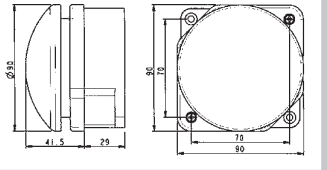
Complementary products

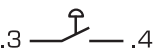
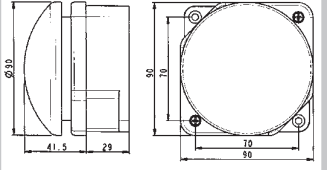
Mushroom Ø 90 station - □ IP66

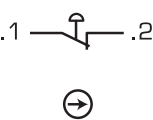
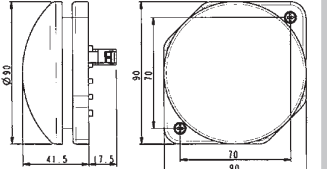
	DESCRIPTION	COLOUR	CONTACT BLOCK	CODE	DIMENSIONS
	Mushroom axial momentary	■	.1  .2	PG1M9W01	
	Mushroom axial momentary	■	.3  .4	PG8M9W10	
	Mushroom axial momentary flush mounting	■	.1  .2	PR1M9W01	

ELECTRICAL CHARACTERISTICS

- Protectione EN60529 IP 66
- Double insulated □
- Number contact capacity max.3 contact blocks
- Cable entry with 3 holes Pg 13,5/M20
- Ambient temperature: operating -25 +70°C
storage -30 +70°C
- Climate protection: IEC 68 2-3 , 2-30
- Terminals referencing: EN 50013
- Colors: Red mushroom RAL 3000,
Giovenzana yellow cover,
Black box RAL 9005,
Black mushroom RAL 3000,
Grey cover RAL 7035,
Black box RAL 3000



Lift

Complementary products

Emergency boxes and fire alarm



LIFT TECHNOLOGY

GENERAL CHARACTERISTICS

- Comply with
 - Contacts in conformity to: IEC947-5-1, EN60947-5-1, UL 508
- Vibration resistance EN60068-2-27
Shock resistance EN60068-2-29
Certifications: cUL, IMQ, CCC, GOST-R, RINA



EMERGENCY FIXING BOX IP 55

Small box at glass breaking for emergency command 110x110x57
Colour: Red
Contact blocks 1NC + 1NO with screw terminals
Double function: Standard with automatic breaking glass operation manual after the glass break and pressure on the push button command in the kit
Green pilot light for localizing (Led 230Vac on request)
Red Light push button (BA9s lamp 220 Vac on request)

CODE

GME01



EMERGENCY BOXES WITH FLUSH LOCKING SYSTEM IP40

Small box with metal locking system and breaking glass for emergency command
Colour: grey RAL 7035
Contact blocks 1NC + 1NO with spring clamp connection
Manual function after the glass broken or cover opening at pressure on the push button command
Lighting red push button (led lampholder 220Vac on request)
Installing in 3 models standard boxes with fixing axes 83,5 mm (100 x 62 x 53 mm)

CODE

GME02

ACCESSORIES

CHANGE GLASS

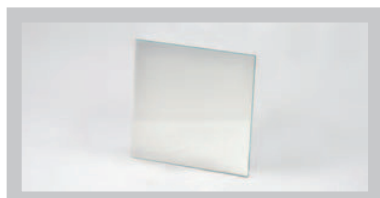

For GME01

GME11

LAMP

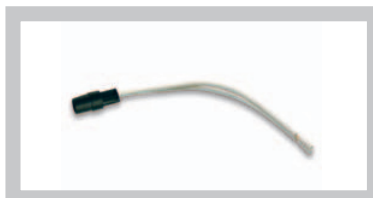

For GME01

Pilot light	GME14
Push button	GME13

LED LAMPHOLDER



For GME02

PCW5L220