

Micro Switches

MFI Series

Table of contents



Standard micro switches with self cleaning contacts
Supplied with operator.

TABLE OF CONTENTS

- MFI Series

pag.125

Micro Switches

MFI Series

DIN 41635A - 6.3x0.8 connectors



AUTOMATION TECHNOLOGIES



- Changeover contacts
- High reliability snap action contacts
- Silver alloy self cleaning contacts
- Positive opening NC contact (⊕)
- 7 versions available
- Certifications:

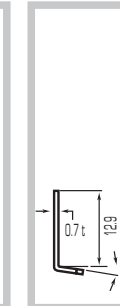
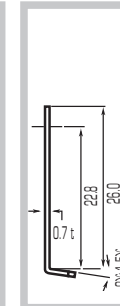
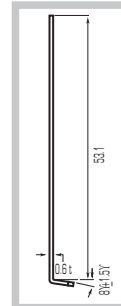
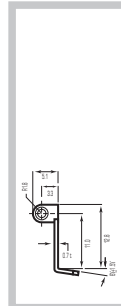
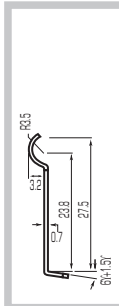
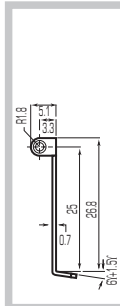
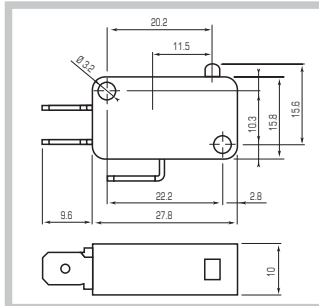

		PIN PLUNGER	LONG ROLLER LEVER	SIMULATED ROLLER LEVER	ROLLER LEVER	LONG LEVER	LEVER	SHORT LEVER
1NC-1NO Snap action (⊕) 	MFI		MFI.1	MFI.2	MFI.3	MFI.4	MFI.5	MFI.6
	Operating force	N	4,5	3,2	3,2	4,5	1,3	3,2
Resetting force	N	1,9	1,2	1,2	1,9	0,15	1,2	1,9
Max pre travel PT	mm	1,4	3,3	3,3	1,4	7,6	3,3	1,4
Min over travel	mm	0,8	0,8	0,8	0,6	2,2	0,8	0,6
Tripping position OP	mm	14,4±0,4	21,8±1,2	18,9±1,2	20±0,6	15,2±1,2	15,2±1,2	15,1±0,5

GENERAL CHARACTERISTICS

■ Comply with	IEC/EN61058, UL1054
■ Rated insulation voltage U_i	250V
■ Rated impulse withstand voltage U_{imp}	1500
■ Rated thermal current I_{th}	8
■ Rated operating current I_e :	8A - 250V resistive load, 3A - 250V inductive load
■ Ambient temperature	-25 +85
■ Electric shock protection	Class II
■ Pollution class	2
■ Life	Mechanical 10^6 , electrical 5×10^5
■ Termination type	6.3x0.8 faston terminal