



Phase Reversing Switch

The MTI Phase Reversing Switch is a manual switch that lets one manually reverse the direction in which a motor is turning. The switch contacts are open and closed manually by moving the switch from the off position to the forward or reverse position.

Note: Do not reverse the phase sequence while the motor is running. Check with your pump supplier to ensure that this device is suitable with your pump.

- ① Lockable, NEMA 3R enclosure (8 x 8 x 6 in.)
- ② 3 Pole, 3 Position Maintained Switch
- ③ Switch is lockable in the off position
- ④ UL Listed Components
- ⑤ Manual Motor Controller 93 ZA

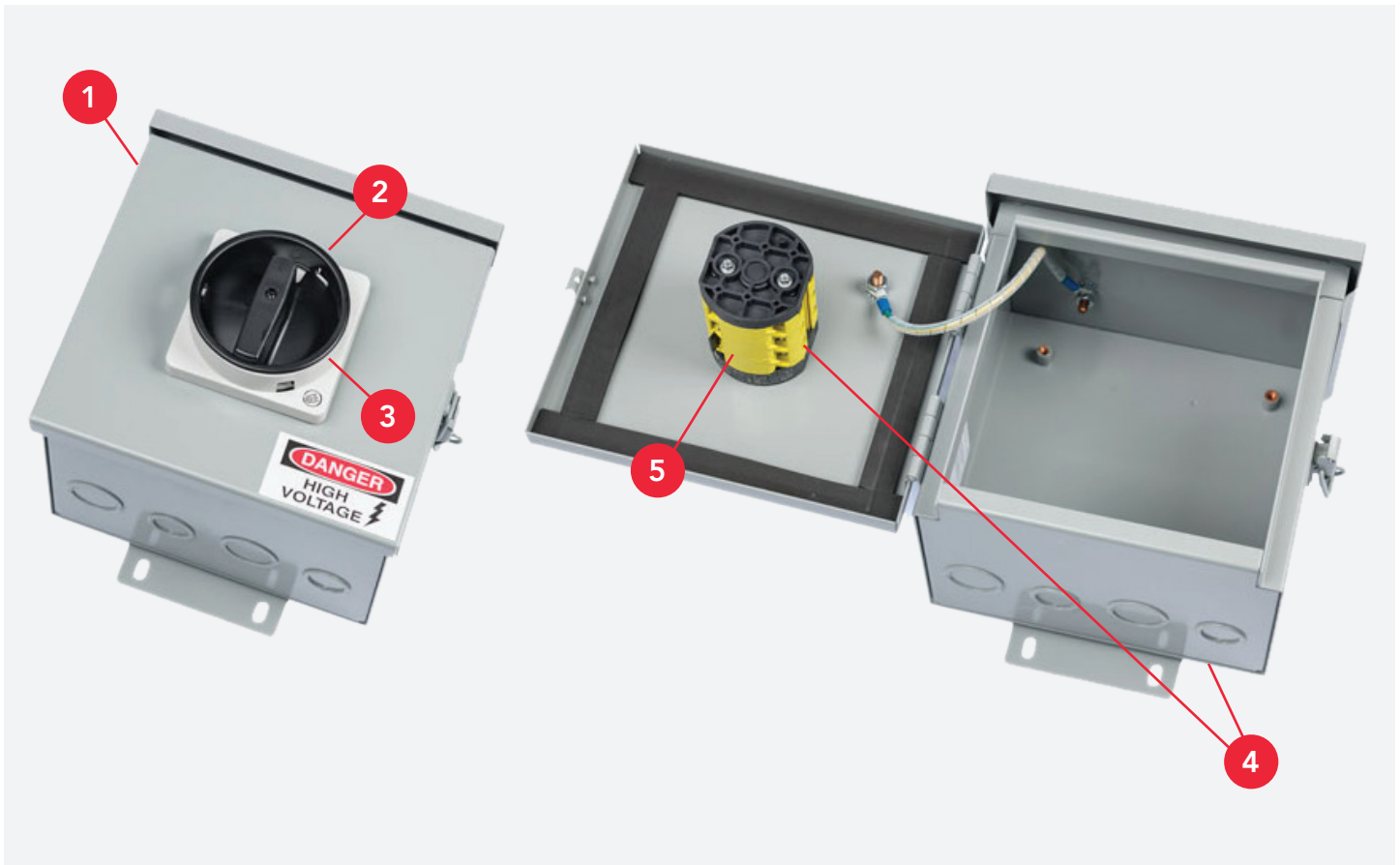

MTI-PRS-40-3PH

General Use 3PH 40A-600V					
Motor	Vac	200	240	480	600
3PH	HP	10	10	20	20

■ CU 60/75 DEGREE : C WIRE ONLY. ■ AWG 6 – 14 ■ TORQUE 12.0 IN.LB.

MTI-PRS-40-3PH

General Use 3PH 40A-600V				
Motor	Vac	240	480	600
3PH	HP	20	40	50

■ CU 60/75 DEGREE : C WIRE ONLY. ■ AWG 3 – 14 ■ TORQUE 10.62 IN.LB.



Motion Technologies, Inc.
1769 West University Dr.
Suite 182
Tempe, AZ 85281

Phone 480-303-9155
Fax 480-303-9058
www.motiontechnologies.com